

# Native Plants in Home Gardens

Building habitat in your landscape



To become a native plant gardener,  
you might look at state and local  
CNPS sites

- [Conservation](#)
- [Education](#)
- [Gardening](#)
- [Rare Plant Science](#)
- [Vegetation Science](#)



# The El Dorado Chapter of the California Native Plant Society is at [eldoradocnps.org](https://www.eldoradocnps.org)

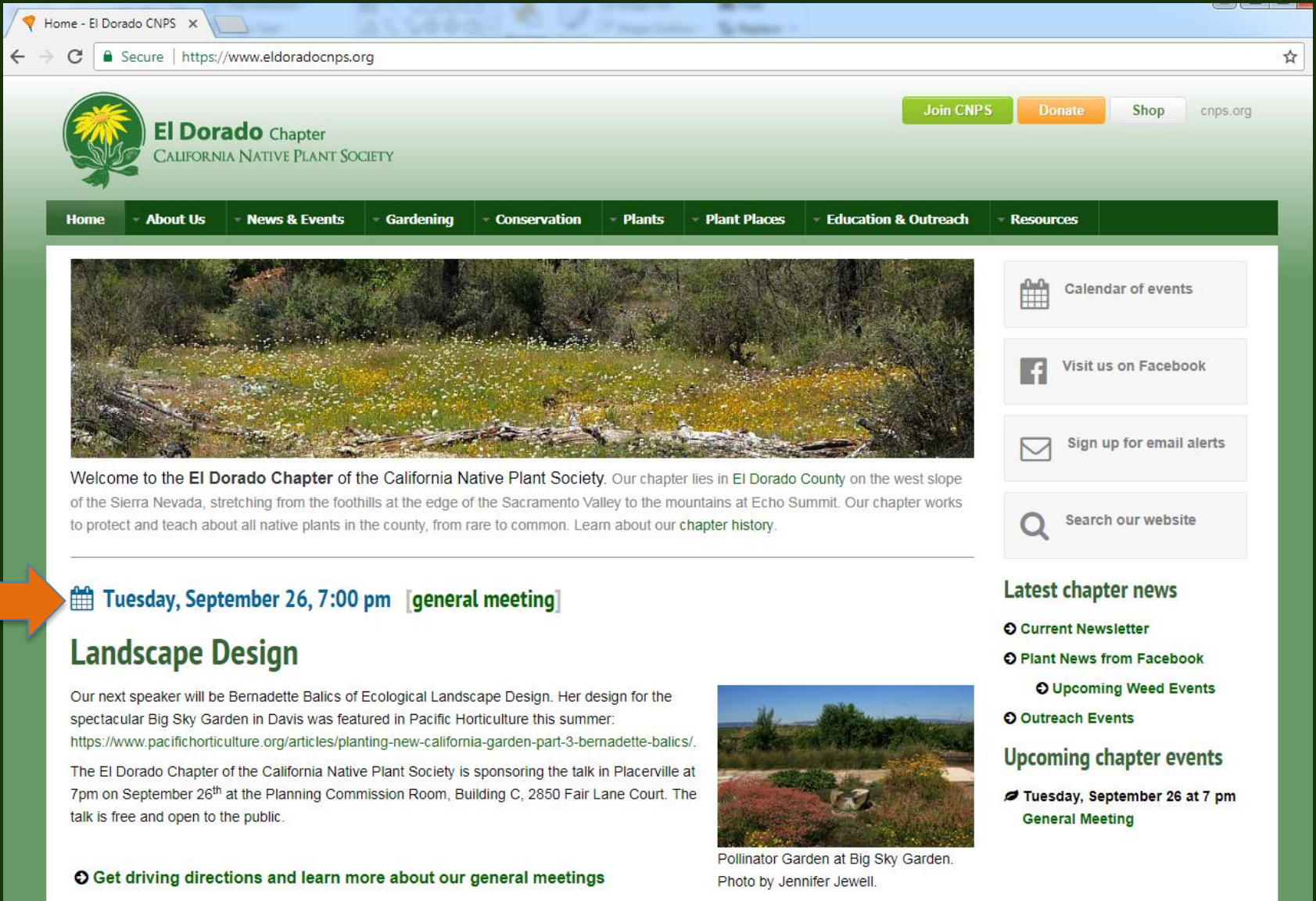

The image is a screenshot of a web browser displaying the homepage of the El Dorado Chapter of the California Native Plant Society. The browser's address bar shows the URL <https://www.eldoradocnps.org>. The website features a green and white color scheme. At the top left is the logo, a green circle containing a yellow flower, with the text "El Dorado Chapter CALIFORNIA NATIVE PLANT SOCIETY" to its right. On the top right, there are three buttons: "Join CNPS" (green), "Donate" (orange), and "Shop" (white), followed by the text "cnps.org". A dark green navigation bar contains the following menu items: Home, About Us, News & Events, Gardening, Conservation, Plants, Plant Places, Education & Outreach, and Resources. The main content area is white. It begins with a large photograph of a field of yellow wildflowers. Below the photo is a welcome message: "Welcome to the El Dorado Chapter of the California Native Plant Society. Our chapter lies in El Dorado County on the west slope of the Sierra Nevada, stretching from the foothills at the edge of the Sacramento Valley to the mountains at Echo Summit. Our chapter works to protect and teach about all native plants in the county, from rare to common. Learn about our chapter history." Below this is a calendar icon followed by the text "Tuesday, September 26, 7:00 pm [general meeting]". An orange arrow points from the left edge of the image to this text. Below the calendar text is the section header "Landscape Design" in a large green font. The text below reads: "Our next speaker will be Bernadette Balics of Ecological Landscape Design. Her design for the spectacular Big Sky Garden in Davis was featured in Pacific Horticulture this summer: <https://www.pacifichorticulture.org/articles/planting-new-california-garden-part-3-bernadette-balics/>. The El Dorado Chapter of the California Native Plant Society is sponsoring the talk in Placerville at 7pm on September 26<sup>th</sup> at the Planning Commission Room, Building C, 2850 Fair Lane Court. The talk is free and open to the public." Below this text is a button with a right-pointing arrow and the text "Get driving directions and learn more about our general meetings". To the right of the text is a photograph of a garden with various plants and a large rock. Below the photo is the caption "Pollinator Garden at Big Sky Garden. Photo by Jennifer Jewell." On the right side of the page, there is a vertical sidebar with several utility boxes: "Calendar of events" (with a calendar icon), "Visit us on Facebook" (with a Facebook icon), "Sign up for email alerts" (with an envelope icon), and "Search our website" (with a magnifying glass icon). Below these boxes is the section header "Latest chapter news" in green. Underneath are four links, each with a right-pointing arrow: "Current Newsletter", "Plant News from Facebook", "Upcoming Weed Events", and "Outreach Events". At the bottom of the sidebar is the section header "Upcoming chapter events" in green, followed by a link with a right-pointing arrow and the text "Tuesday, September 26 at 7 pm General Meeting".

 **Tuesday, September 26, 7:00 pm** [general meeting]

## Landscape Design

Our next speaker will be Bernadette Balics of Ecological Landscape Design. Her design for the spectacular Big Sky Garden in Davis was featured in Pacific Horticulture this summer: <https://www.pacifichorticulture.org/articles/planting-new-california-garden-part-3-bernadette-balics/>.

The El Dorado Chapter of the California Native Plant Society is sponsoring the talk in Placerville at 7pm on September 26<sup>th</sup> at the Planning Commission Room, Building C, 2850 Fair Lane Court. The talk is free and open to the public.

 [Get driving directions and learn more about our general meetings](#)



Pollinator Garden at Big Sky Garden.  
Photo by Jennifer Jewell.

 [Calendar of events](#)

 [Visit us on Facebook](#)

 [Sign up for email alerts](#)

 [Search our website](#)

### Latest chapter news

-  [Current Newsletter](#)
-  [Plant News from Facebook](#)
-  [Upcoming Weed Events](#)

 [Outreach Events](#)

### Upcoming chapter events

 [Tuesday, September 26 at 7 pm  
General Meeting](#)

## Redbud-cnps.org covers Placer and Nevada counties

Redbud Chapter Californ... X

← → ↻ ⓘ redbud-cnps.org

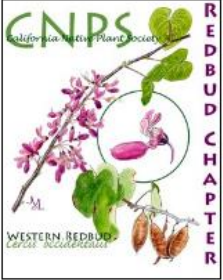

# The Redbud Chapter of CNPS

[Second Edition of \*Wildflowers of Nevada and Placer Counties\* NOW AVAILABLE!!](#)



CNPS Redbud Chapter

Welcome

**2017 Fall Plant Sale**

[Field Trips](#)  
[Newsletters](#)  
[Local Floras](#)  
[Natives for Landscaping](#)  
[Photo Gallery](#)  
[Other Links](#)

[About Our Chapter](#)  
[How to Join Redbud-CNPS](#)  
[How to Reach Us](#)

[Redbud's Facebook Page](#)

[Plant Sale on Facebook](#)



The Redbud Chapter of the California Native Plant Society welcomes all native-plant lovers in Nevada and Placer counties. We are dedicated to exploring, educating, researching, and writing about the diversity and beauty of our native flora. We:

- Lead field trips to stunning foothill and mountain wildflower displays.
- Offer 100s of locally adapted, hand-picked native plants at our fall sale.
- Advocate for native flora and organize conservation projects.
- Meet up to propagate plants and learn ethnobotany first-hand.
- Publish two books on over 700 local wildflowers, trees and shrubs.

Together, we explore and restore nature, and find new friends!



# Sherwood Demonstration Garden

Next to  
Folsom Lake  
College, back  
by the  
Observatory



# The Sherwood Demo Garden has a native section, with an example of grouping by plant community

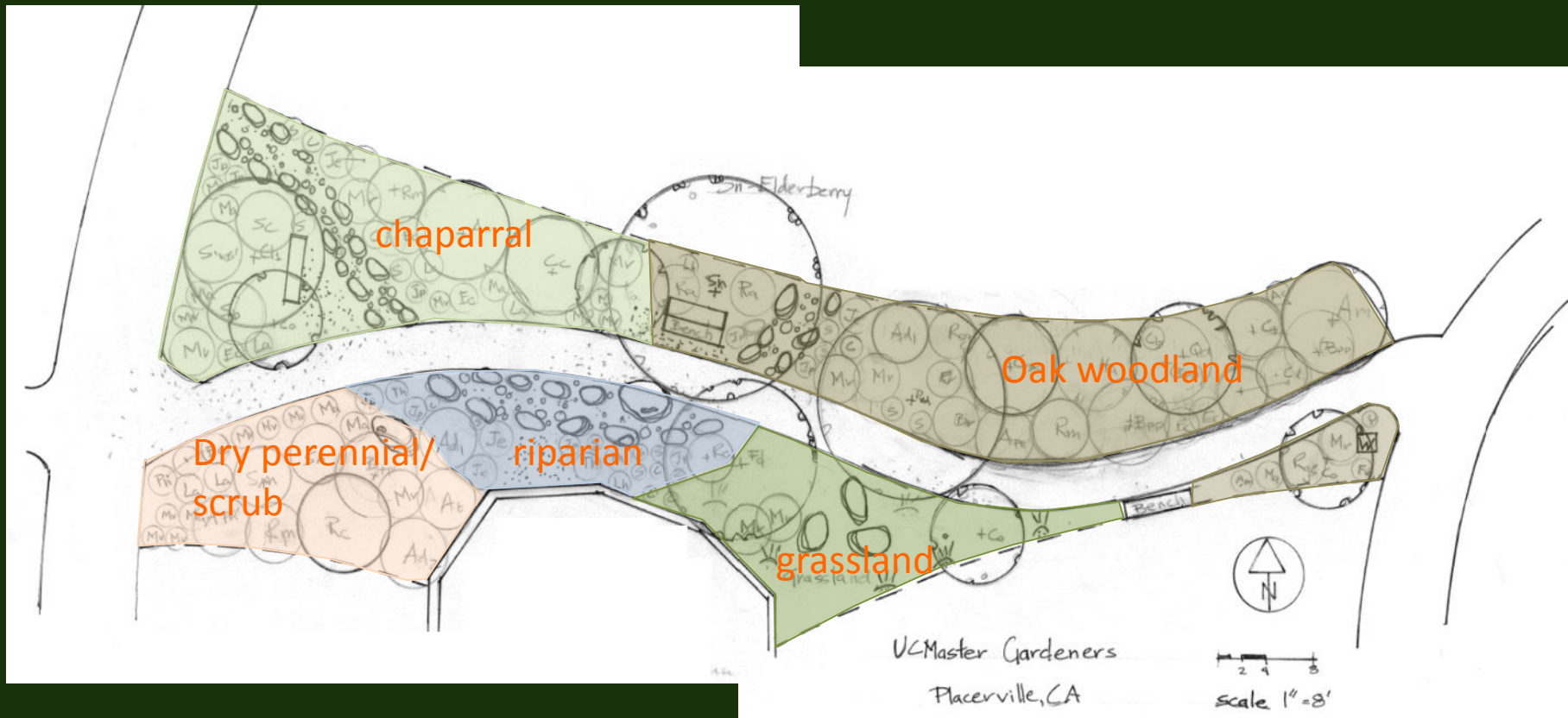



# American River Conservancy Native Garden

## Wakamatsu Farm on Cold Springs Rd

Private property, by appt, call 530-621-1224

OPEN FARM DAYS: 1<sup>st</sup> Saturdays in Oct, Nov



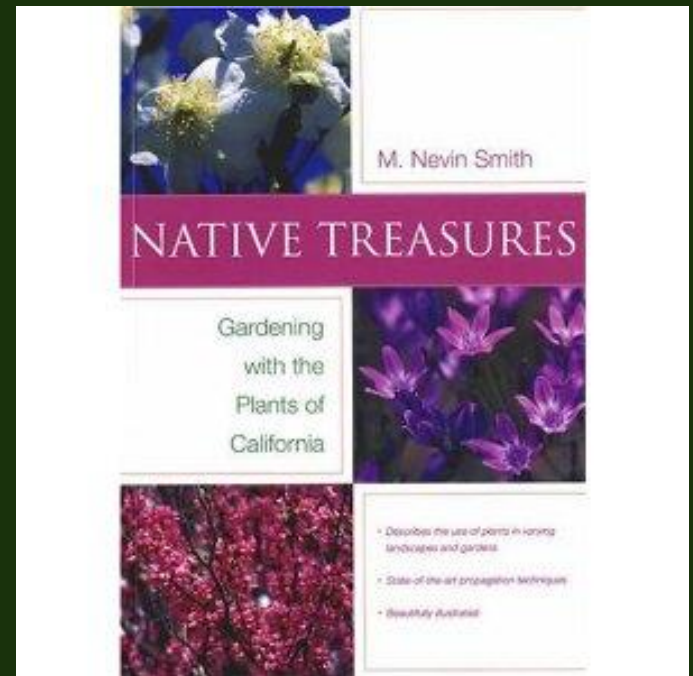
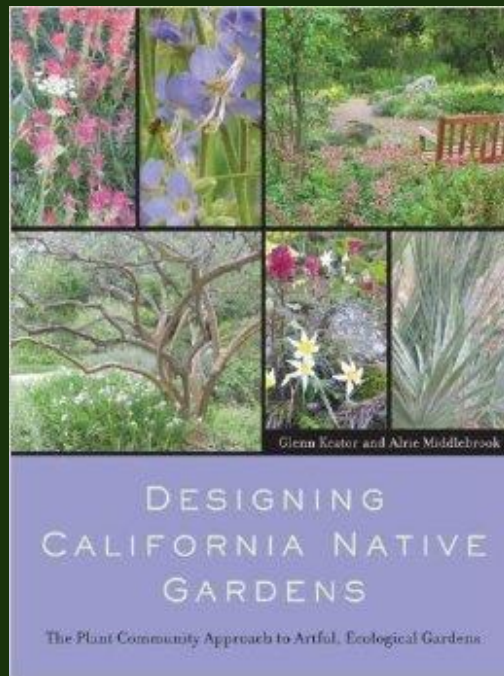
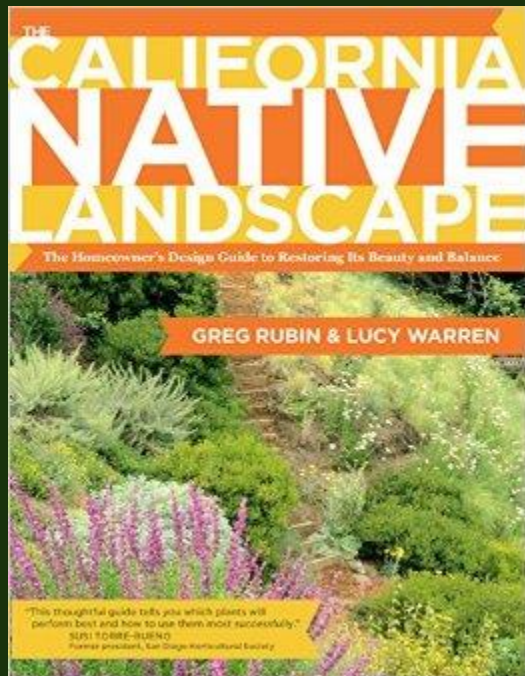





# UC Davis Arboretum

## California Native Plant Garden



home ::



# All-Stars Plant Search

**Plant Name:**

**Type:**  Tree  Shrub  Groundcover  Vine  Perennial

**Size:**  Small  Medium  Large

**Exposure:**  Full Sun  Part Shade  Shade

**California Native**

[\[reset\]](#) [\[show/hide more criteria\]](#)

- PLAN YOUR VISIT
- GARDENING
- EDUCATION & RESEARCH
- GATEWAYS PROJECT
- SUPPORT
- VOLUNTEER

- Arboretum All-Stars
- California Native Garden
- Low Maintenance Garden
- Wildlife Attracting Garden
- All-Stars Plant Search**
- Plant Sales/ Nursery
- Gardening Reference
- Resources



- ABOUT US
- CALENDAR
- ARBORETUM ALL-STARS
- MEMBERSHIP
- NEWS





Plant  
Name:

Search by Name

Type:  Tree  Shrub  Groundcover  Vine  Perennial

Size:  Small  Medium  Large

Exposure:  Full Sun  Part Shade  Shade

California Native

[reset]

[show/hide more criteria]

Search by Criteria

EDUCATION  
& RESEARCH

GATEWAYS  
PROJECT

SUPPORT  
VOLUNTEER

California Native  
Garden

Low Maintenance  
Garden

Wildlife Attracting  
Garden

**All-Stars  
Plant Search**

Plant Sales/  
Nursery

Gardening  
Reference

Resources

ABOUT US

CALENDAR

ARBORETUM  
ALL-STARS

MEMBERSHIP

NEWS



***Ceanothus maritimus* 'Valley Violet'** - valley violet maritime ceanothus  
California native plant; best small ceanothus for Central Valley gardens;  
clusters of dark-violet flowers bloom in spring; attracts beneficial insects.  
[More Details](#)



***Salvia apiana*** - California white sage  
California native plant; spring flowers attract pollinating bees; leaves contain  
fragrant oils.  
[More Details](#)



***Salvia clevelandii* 'Winnifred Gilman'** - Winnifred Gilman Cleveland sage  
California native plant; evergreen shrub produces maroon-stemmed, blue-  
violet flowers; heat and drought tolerant; attracts hummingbirds, butterflies  
and beneficial insects.  
[More Details](#)



***Viguiera parishii*** - desert goldeneye  
California native plant; golden daisies blossom from early spring until mid-fall  
among triangular-shaped green leaves; tolerates full sun or part shade and is  
low maintenance.  
[More Details](#)





# California Native Garden

Plant this California Native Garden at home. The design below was developed for your home garden by Arboretum experts. The plan below is based on a 10-foot by 10-foot garden bed.

***Berberis aquifolium***  
**'Compacta'**  
compact Oregon grape



details

***Bouteloua gracilis***  
blue grama grass



details

***Heteromeles arbutifolia***  
toyon, christmas berry  
California holly



details

***Muhlenbergia rigens***  
deergrass



details

CALIFORNIA NATIVE PLAN

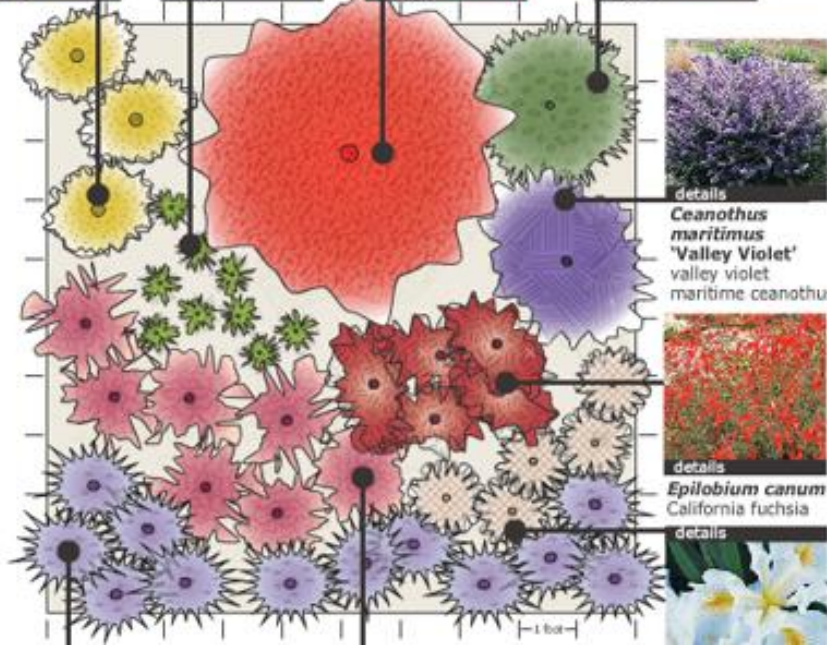

details

***Ceanothus maritimus***  
**'Valley Violet'**  
valley violet  
maritime ceanothus



details

***Epilobium canum***  
California fuchsia



details

- PLAN YOUR VISIT
- GARDENING
- EDUCATION & RESEARCH
- GATEWAYS PROJECT
- SUPPORT
- VOLUNTEER

- Arboretum All-Stars
- California Native Garden**
- Low Maintenance Garden
- Wildlife Attracting Garden
- All-Stars Plant Search
- Plant Sales/Nursery
- Gardening Reference Resources

- ABOUT US
- CALENDAR
- ARBORETUM ALL-STARS
- MEMBERSHIP
- NEWS





# National Wildlife Federation

## Best host plants for butterflies and moths, by zip code

<http://nwf.org/Garden-For-Wildlife/About/Native-Plants.aspx>

nwf.org »

DONATE TAKE ACTION

 National Wildlife Federation's  
**GARDEN FOR WILDLIFE™**

 WILDLIFE TIPS & TRICKS



 CERTIFY YOUR HABITAT

 HELP THE BUTTERFLIES

ABOUT CREATE FOOD WATER COVER YOUNG SUSTAINABILITY WILDLIFE CERTIFY

# About

KIP KRIEGER

### Native Plants

- Native Plant Types
- Milkweed for Monarchs
- Nectar Plants for Monarchs
- Regional Examples
- Find Available Native Plants

### Impact of Wildlife Gardens

### National Initiatives

- Pollinators and Monarchs
- Mayors' Monarch Pledge
- Urban Monarch Conservation Plans
- Tri-National Mayors' Monarch Pledge

### Program Partners

- National Garden Club

### Spread the Word

### Resources

## Native Plants



David Mizejewski

Native plants have formed symbiotic relationships with native wildlife over thousands of years, and therefore offer the most sustainable habitat. A plant is considered native if it has occurred naturally in a particular region, ecosystem, or habitat without human introduction.

Exotic plants that evolved in other parts of the world or were cultivated by humans into forms that don't exist in nature do not support wildlife as well as native plants. Occasionally, they can even escape into the wild and become invasive exotics that destroy natural habitat.

Native plants help the environment the most when planted in places that match their growing requirements. They will thrive in the soils, moisture and weather of your region. That means less supplemental watering, which can be wasteful, and pest problems that require toxic chemicals. Native plants

# How native is it?

- California native?
- El Dorado County native?
- Native to your neighborhood?

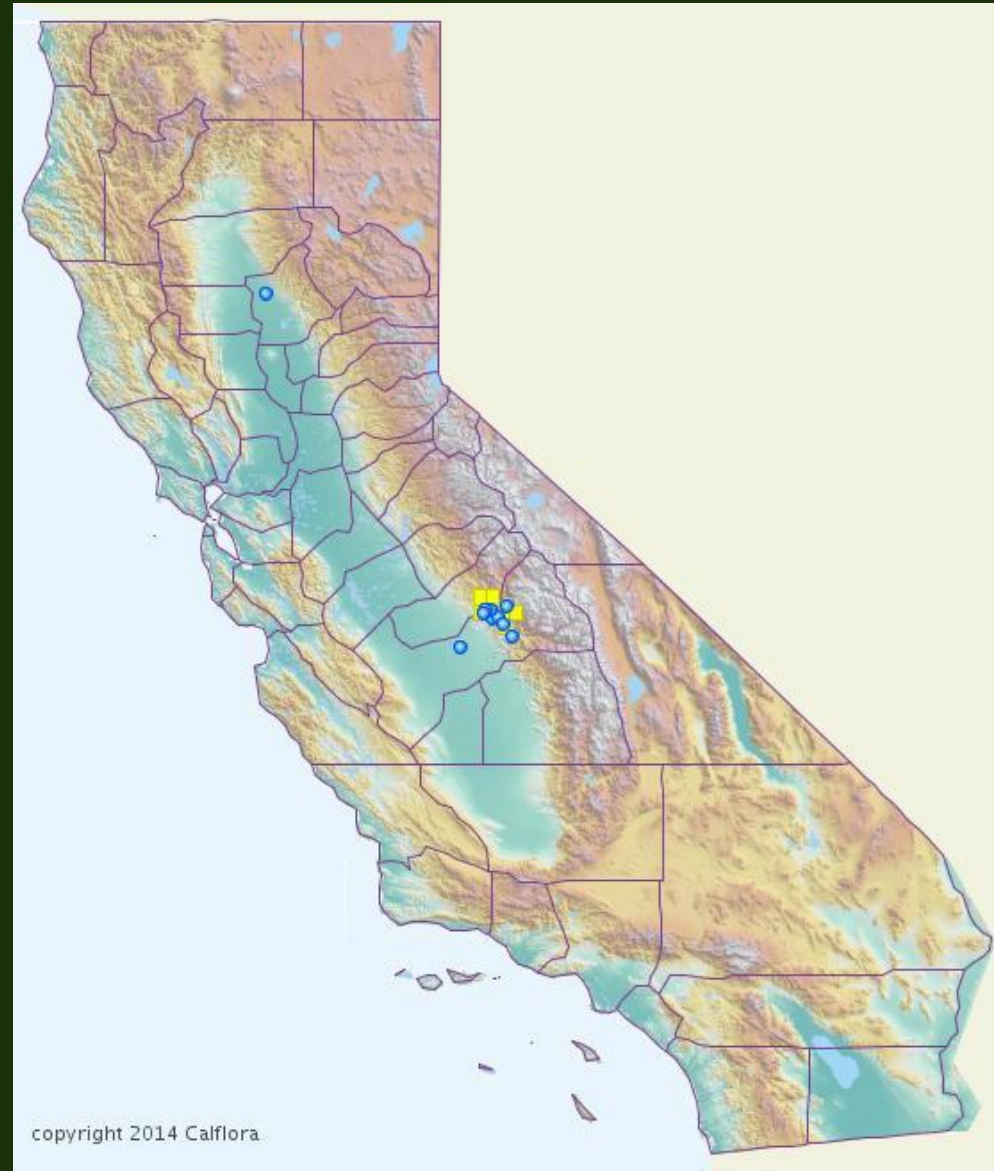



# The granddaddy of online plant selection tools



information on **wild California plants** for conservation, education, and appreciation

- [My Calflora](#)
- [My Observations](#)
- [What Grows Here?](#)
- [Observation Hotline](#)
- [Great Places](#)
- [donate](#)
- [News](#)
- [About Calflora](#)
- [Add Observations](#)
- [Phone Applications](#)
- [Weed Manager](#)
- [NRCS eVegGuide](#)

## Search for Plants

[HELP](#)

Common Names [A](#) [B](#) [C](#) [D](#) [E](#) [F](#) [G](#) [H](#) [I](#) [J](#) [K](#) [L](#) [M](#) [N](#) [O](#) [P](#) [Q](#) [R](#) [S](#) [T](#) [U](#) [V](#) [W](#) [X](#) [Y](#) [Z](#)

Scientific Names [A](#) [B](#) [C](#) [D](#) [E](#) [F](#) [G](#) [H](#) [I](#) [J](#) [K](#) [L](#) [M](#) [N](#) [O](#) [P](#) [Q](#) [R](#) [S](#) [T](#) [U](#) [V](#) [W](#) [X](#) [Y](#) [Z](#)

Family Names [A](#) [B](#) [C](#) [D](#) [E](#) [F](#) [G](#) [H](#) [I](#) [J](#) [K](#) [L](#) [M](#) [N](#) [O](#) [P](#) [Q](#) [R](#) [S](#) [T](#) [U](#) [V](#) [W](#) [X](#) [Y](#) [Z](#)

plant name  [NAME WIZARD](#)

Enter part of a name: common scientific or FAMILY  
poppy Papaver POACEAE

**duration**  Annual  Perennial  Biennial

**lifeform**  Grasslike  Tree  Herb  Fern  Shrub  Vine

**status**  Native to California  Not native to California  Cal-HPC invasive plants  CNPS rare plants  Affinity to serpentine soil

**community**   
Alkali Sink  
Alpine Fell-fields  
Bristle-cone Pine Forest  
Chaparral  
Closed-cone Pine Forest

**category**  Monocot  Dicot  Gymnosperm  Pteridophyte

**result format**  [more ...](#) Order by

- county**
- any
  - Alameda
  - Alpine
  - Amador
  - Butte
  - Calaveras
  - Contra Costa
  - Colusa
  - Del Norte
  - El Dorado
  - Fresno
  - Glenn
  - Humboldt
  - Imperial
  - Inyo
  - Kings
  - Kern
  - Lake
  - Lassen
  - Los Angeles
  - Madera
  - Marin
  - Mariposa
  - Mendocino
  - Merced
  - Mono
  - Monterey
  - Modoc
  - Napa
  - Nevada
  - Orange
  - Placer

▶ PLANT FILTER

▶ PLANT NAMES

▶ RESULTS

▼ AREA

- in map area
- in polygon

▼ DRAW A POLYGON

start drawing

SEARCH

▶ POINTS



▼ AREA

- in map area
- in polygon

▼ DRAW A POLYGON

Click on the map to set the vertices of a polygon.

Drag a vertex to move it. Click on a vertex to delete it.

stop drawing

SEARCH

▶ POINTS

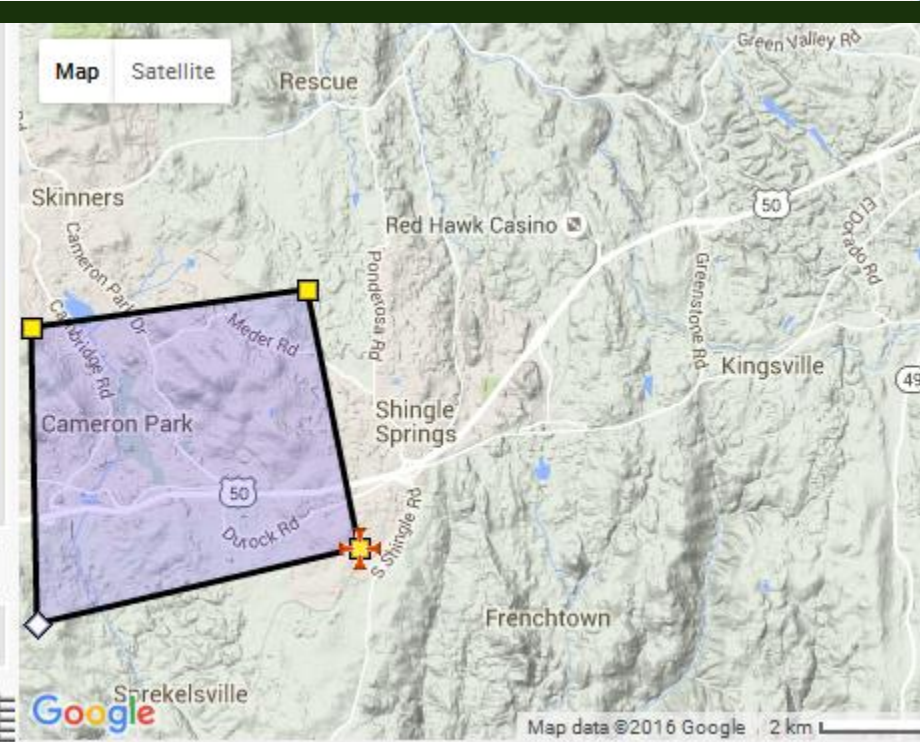



native

Perennial herb

LILIACEAE



2001 Jeff Abbas



2003 Michael Charters



Jo-Ann Ordan  
Academy

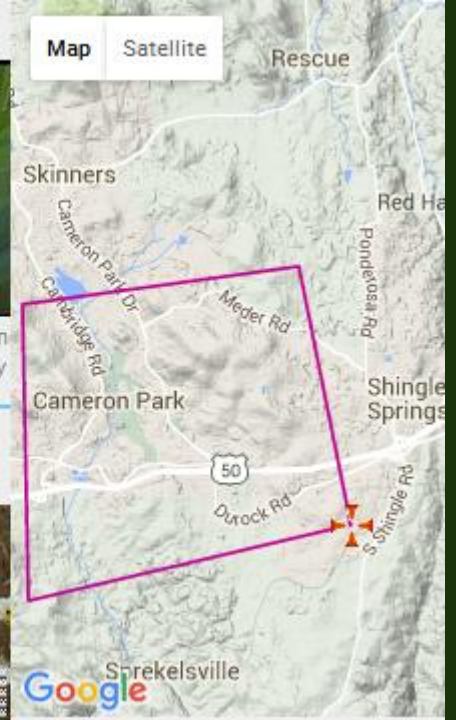

**Calochortus superbus** *Yellow mariposa*

1 record (1 CCH)

native

Perennial herb

LILIACEAE



2007 Carol W. Witham



2010 Barry Breckling

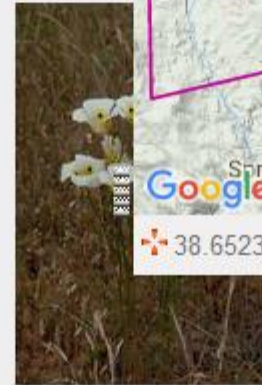

2010 Dee E. Warenycia

38.6523, -120.9457



**Calycadenia multiglandulosa** *Rosin weed*

3 records (2 CCH)

native

Annual herb

ASTERACEAE



2008 Dee E. Warenycia



2009 Neal Kramer



2009 Neal Kramer





# Toyon

*Heteromeles arbutifolia*







Communities:  
Chaparral,  
Foothill woodland  
Habitat: canyons,  
slopes

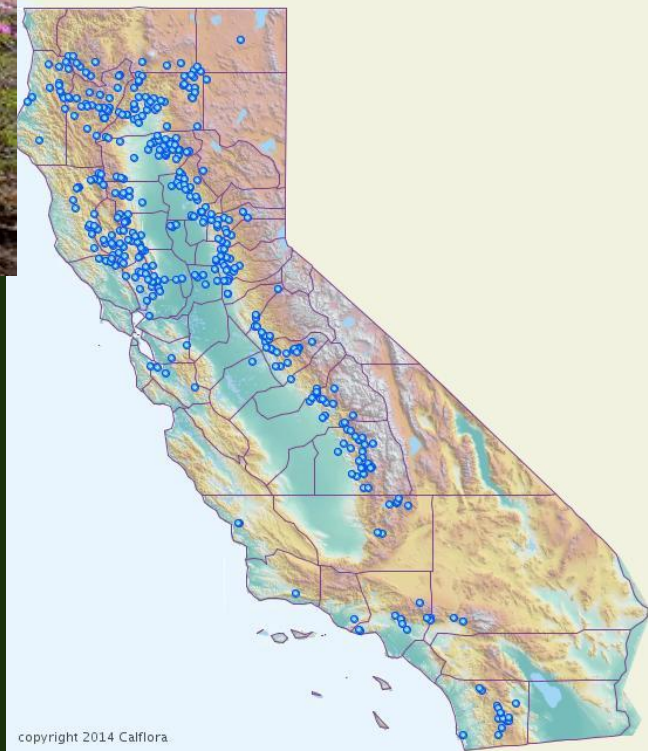

Western redbud  
*Cercis occidentalis*





Western Azalea  
*Rhododendron occidentale*

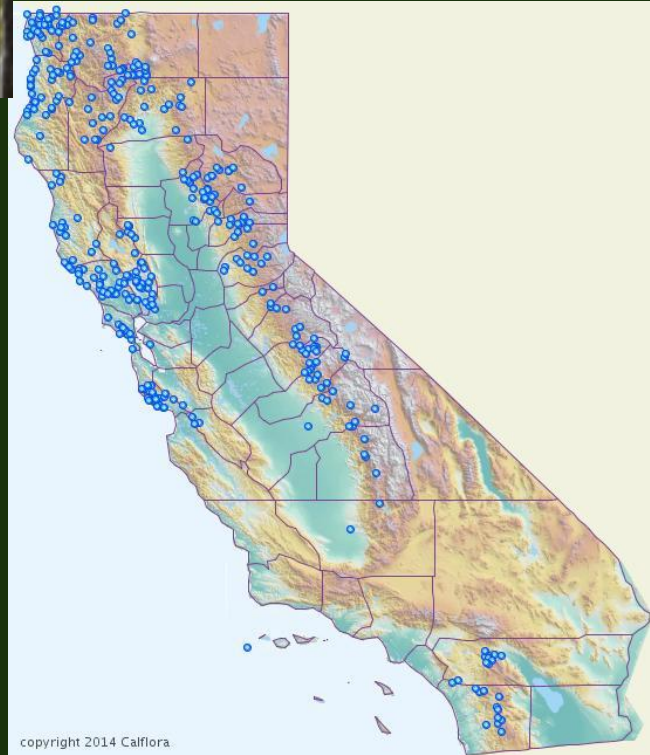





Flannelbush  
*Fremontodendron decumbens*

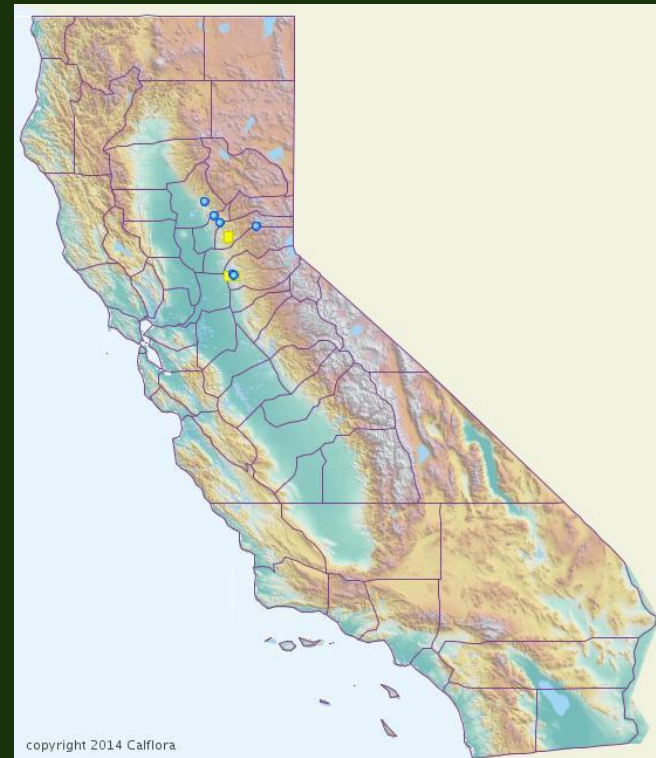

🏠 To see descriptions of the plants native to your location, enter a California address or click on the map.

Plants Native To :



All Plants  
( 2216 )



Trees  
( 161 )



Shrubs  
( 561 )



Perennials  
( 1081 )



Annuals  
( 256 )



Grasses  
( 210 )



Succulents  
( 84 )



Vines  
( 29 )



Sun  
( 1582 )



Shade  
( 287 )



Part Shade  
( 1038 )



Bird And Butterfly  
Plants  
( 583 )



Groundcovers  
( 151 )



Hedges  
( 125 )



Chaparral  
( 702 )



Riparian  
( 569 )

Click the map to select a Location





Plants Native To : 

Number of plants : 199

Sort By : 

1

**Blue Eyed Grass**

Sisyrinchium bellum

[Add to My Plants](#)

2

**California Fuchsia**

Epilobium canum

[Add to My Plants](#)

3

**Western Columbine**

Aquilegia formosa

[Add to My Plants](#)

4

**Foothill Penstemon**

Penstemon heterophyllus

[Add to My Plants](#)

5

**Scarlet Monkeyflower**

Mimulus cardinalis

[Add to My Plants](#)

6

**California Goldenrod**

Solidago velutina ssp. californica

[Add to My Plants](#)

7

**Checker Bloom**

Sidalcea malviflora

## Blue Eyed Grass

Sisyrinchium bellum

Add to My Plants



© 2013 Calscape



### Estimated Natural Range

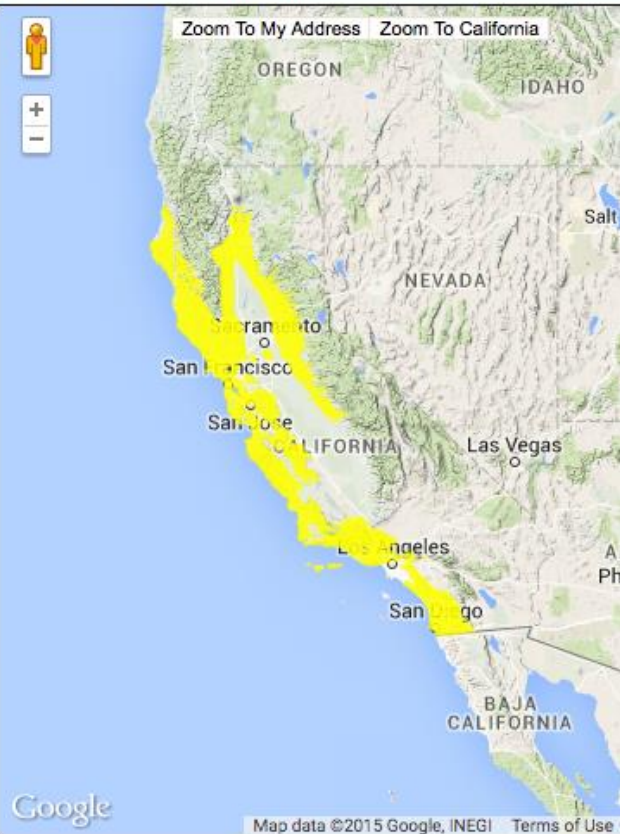

Sources Include: Data provided by the participants of the Consortium of California Herbaria

### Summary Description

Plant Type	Perennial herb
Maximum Height	1 feet
Site Type	Meadows, seasonally moist grasslands
Sun	Sun, Part Shade





How do you want your yard to look in 5 years?



# Identify the dominant plant communities for your yard

Blue Oak

Interior Live Oak

Grey pine

Western redbud

Toyon

Manzanita

Chamise

Buckbrush

Coyote brush





# Evaluate your own goals

- Save water
- Reduce workload
- Attract birds and butterflies
- Save species from extinction

Natives (species and cultivars), and low-water, probably Mediterranean

Natives (species and cultivars) and their close relatives, and “butterfly garden” plants

Native species and varieties

Consider  
structural plants  
first

Protect oaks

Add high-value species  
for ecosystem

## LAYERS OF A DESIGNED PLANT COMMUNITY





Consider adult plant size

Example:

Giant wild rye

*Elymus condensatus*

“Lotties choice”

Matilija poppy



Note varieties and cultivars:

**Variety:** grows in nature, reproduces true to type

**Cultivar:** cultivated variety, may or may not reproduce true to type

*Are often cloned in the nursery trade*



*Zauschneria californica mexicana*



*Zauschneria californica 'Calistoga'*







# Design with dormancy in mind









Grouping can  
help









Or appreciate the natural look





# Evergreens

Example:

**Bush Anemone**

*Carpenteria  
californica*  
'Elizabeth'





Dwarf coyote bush

*Baccharis pilularis* “Pigeon Point”





Plan to do some  
maintenance

You'll dead-head  
and cut back as  
needed



# Finding Plants

## Native Plant Sales



El Dorado CNPS:

First Saturday in April and October

Master Gardener Plant Sale:

Spring, sometimes Fall but not in 2017

Propagate



Examine plants  
before you buy



- Plant when soil is warm and you anticipate seasonal rainfall
- Plant in plant community zones, by water needs
- Do not amend soil in the planting hole
- Top dress with leaves, compost, mulch, small rocks, as appropriate for the zone
- Be tolerant of insect damage





Water to establish, usually 1-3 years:

1<sup>st</sup> summer: once a week

2<sup>nd</sup> summer: 2-3 times a month, deeper

3<sup>rd</sup> summer: 1-2 times total, very deep

4<sup>th</sup> summer: 0

Water in the early morning



Established  
plants show  
significant  
new leaf  
growth

This can take  
1-3 years





# Most gardeners over water

**Don't!**

Check soil with fingers--is it damp?

If YES, don't water!

If NO, maybe water

Do not water if going dormant  
or showing signs of fungal wilt

Not during heat of day



Once established, revise watering, especially in drought. **Emulate winter and spring rains if needed.**

# UC Davis plant trials



## *Goal:*

Find native plants for commercial nursery trade that use less water and fewer chemicals

## *Method:*

Chose 10 underused/unused native plants

- Established 24 of each in a hot sunny field for 2 years
- Once established, tested 4 watering regimes
- Evaluated for foliage, flowering, vigor



# Native plants are survivors

Palmer Oak,  
*Quercus palmeri*

13,000 years old







© Candace Fallon, The Xerces Society





Solidago-  
goldenrod



Heuchera-  
Coral bells





Oregon Grape  
*Mahonia aquifolium*  
*Berberis aquifolium*





**Creeping mahonia**  
*Berberis aquifolium* var. *repens*





yarrow



Sticky monkeyflower



Lupine



Linum- western blue flax



Douglas Iris



Mimulus cardinalis

© 2003 Heperstance Garden



Narrowleaf Milkweed

*Asclepias fascicularis*

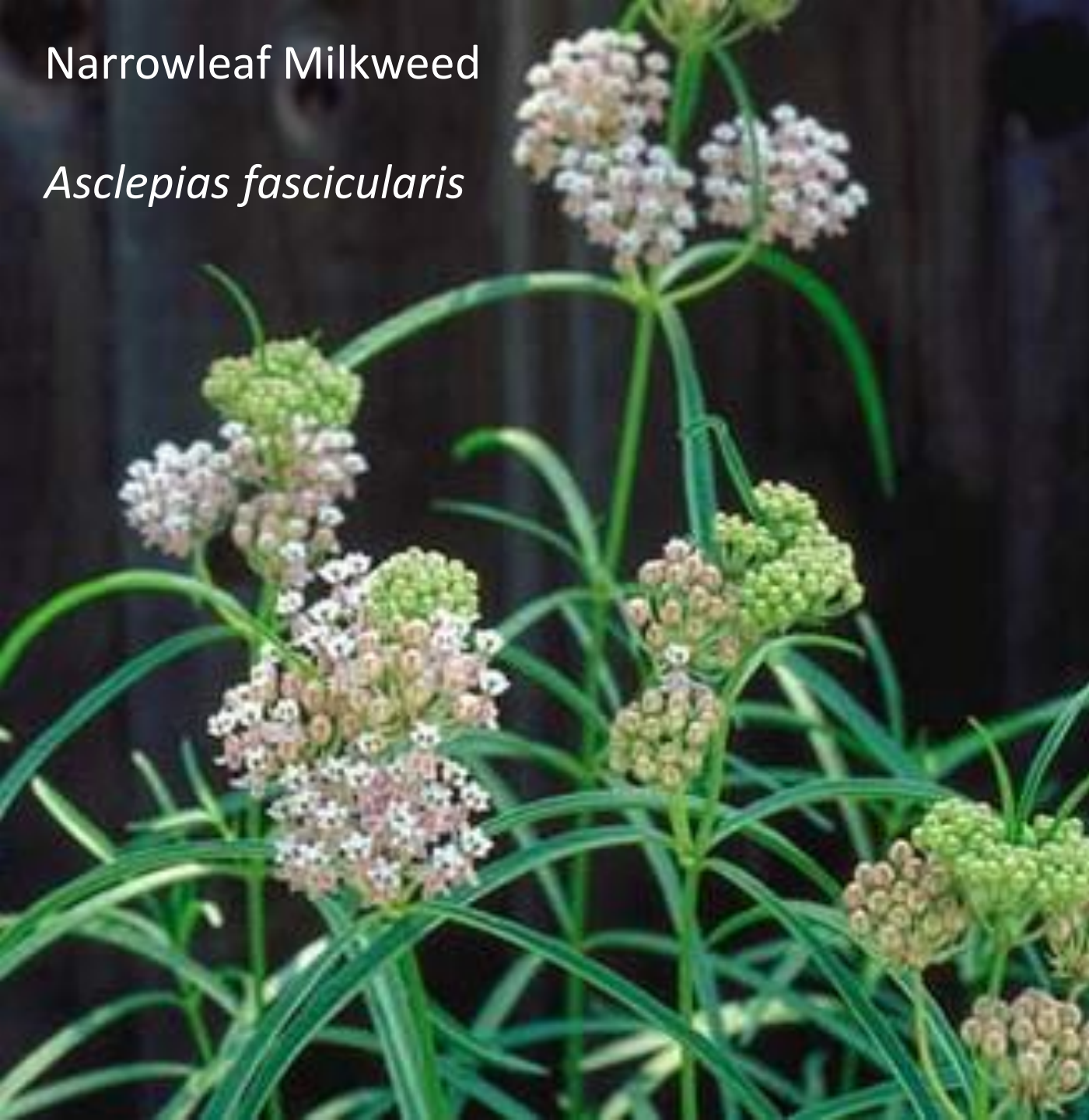

Showy Milkweed

*Asclepias speciosa*







Mock Orange  
*Philadelphus lewisii*  
Ssp. *californicus* 'Covelo'





Western Columbine

Spice bush







Wild ginger



Salal



*Gaultheria shallon*





Woodland strawberry

Wild grape

