

1 All-Star Garden

This garden reflects the UC Davis Arboretum approach to introducing plants that perform well in areas like Butte County. New plants are added based on the experiences of Master Gardeners in our county. Learn more about the all-star plants at ucanr.edu/p/57979.

2 Mediterranean Garden

This garden exhibits plants that do well in Mediterranean climates. These plant choices may shift over time as climate changes occur in our area. Although we have had cool, wet winters, our winters are becoming shorter and may be warmer in the future.

3 Espalier Garden

The ancient art of training fruit trees in a flat, two-dimensional pattern by pruning and tying limbs to frames in a systematic style is demonstrated in this garden. Espaliering can be an ideal form of growing fruit trees in a small area as well as controlling tree height (while still yielding a substantial crop output).

4 Berm Garden

Hillside gardening and gardens built on berms demonstrate how to garden successfully in areas that may be challenging when it comes to irrigation and soil retention or soil that is not ideal.

5 Herb Garden

Plants that have dual purposes (as seasonings to enhance foods and for aesthetics) are beneficial and can enrich the garden as a whole. The convenience of growing an herb garden near the home kitchen has made it a staple in many gardens throughout history.

6 Backyard Orchard

There are several varieties of trees in this

garden; all are pruned to a height that allows easy harvesting of the fruit, while maintaining tree health.

7 California Native Garden

This garden consists solely of plants that are native to California. There are many different habitats across the state, resulting in a variety of species that may occur in coastal, inland valleys, or desert areas. Regardless of the habitat in which they are found, all plants in this garden are adapted to wet winters and hot dry summers. These plants play an important role in providing habitat and food for insects, pollinators, and wildlife that are also native to California.

8 Wildlife Habitat Garden

Native plants growing around rocks, logs, and a fountain help make this garden attractive to fauna by providing food, shelter, and nesting areas. Animals can be beneficial as they add life to the garden and are fun to watch.

9 Summer Dry Garden

Plants chosen for this garden need little to no supplemental water once established and are often resistant to pests. Dry gardens require minimal preparation, as no soil amendments are added and there is little digging and raking needed. New plants start out on a regular watering schedule which is slowly reduced as the plants mature (approximately two growing seasons).

10 Succulent Garden

As garden plant choices transition with a changing climate, succulents have become popular. With their unusual leaves and structures, they can look exotic or cool and green along a garden path and are colorful in containers or a border. Succulents are very low maintenance plants: another plus.

11 Heritage Almond Orchard

In keeping with the Patrick Ranch Museum's devotion to "our community's rich agricultural heritage," a half-acre orchard of heirloom almonds was planted in 2011. Varieties represent the California almond industry's beginnings prior to 1900 and include those planted by early agricultural pioneers. Today, this California industry covers more than 1.5 million acres. Since its selection in 1879, Nonpareil remains the most important California almond variety!

12 Under the Oaks

Gardens under oaks require special considerations for the protection and longevity of the trees. Plants here were selected for their tolerance for shade in summer and sun in winter, and their ability to withstand the low water conditions in summer required by oaks. Oaks do not need additional mulch.

13 Australian Garden

This garden displays Australian plants that are not from the Mediterranean climate area of Australia, but are nonetheless suitable for the climate and conditions in our demonstration garden. These plants are becoming popular and many can now be found in local nurseries.

14 Edible Garden

The Edible Garden showcases a wide variety of edible plants and demonstrates what an average homeowner could accomplish in a backyard setting. Over thirty types of plants are featured, and at least one part of each plant (fruits, flowers, leaves, roots, seeds, stems) is edible. The hardscape components and design strategies used here are either easy to make or available to purchase. Attractive curving paths also facilitate the maintenance and harvesting of edibles.



Demonstration Garden Self-Guided Tour



UC Master Gardeners of Butte County
ucanr.edu/sites/bcmg/

Patrick Ranch Museum
10381 Midway
Durham, CA 95938

www.patrickranchmuseum.org

UC Master Gardeners of Butte County Demonstration Garden

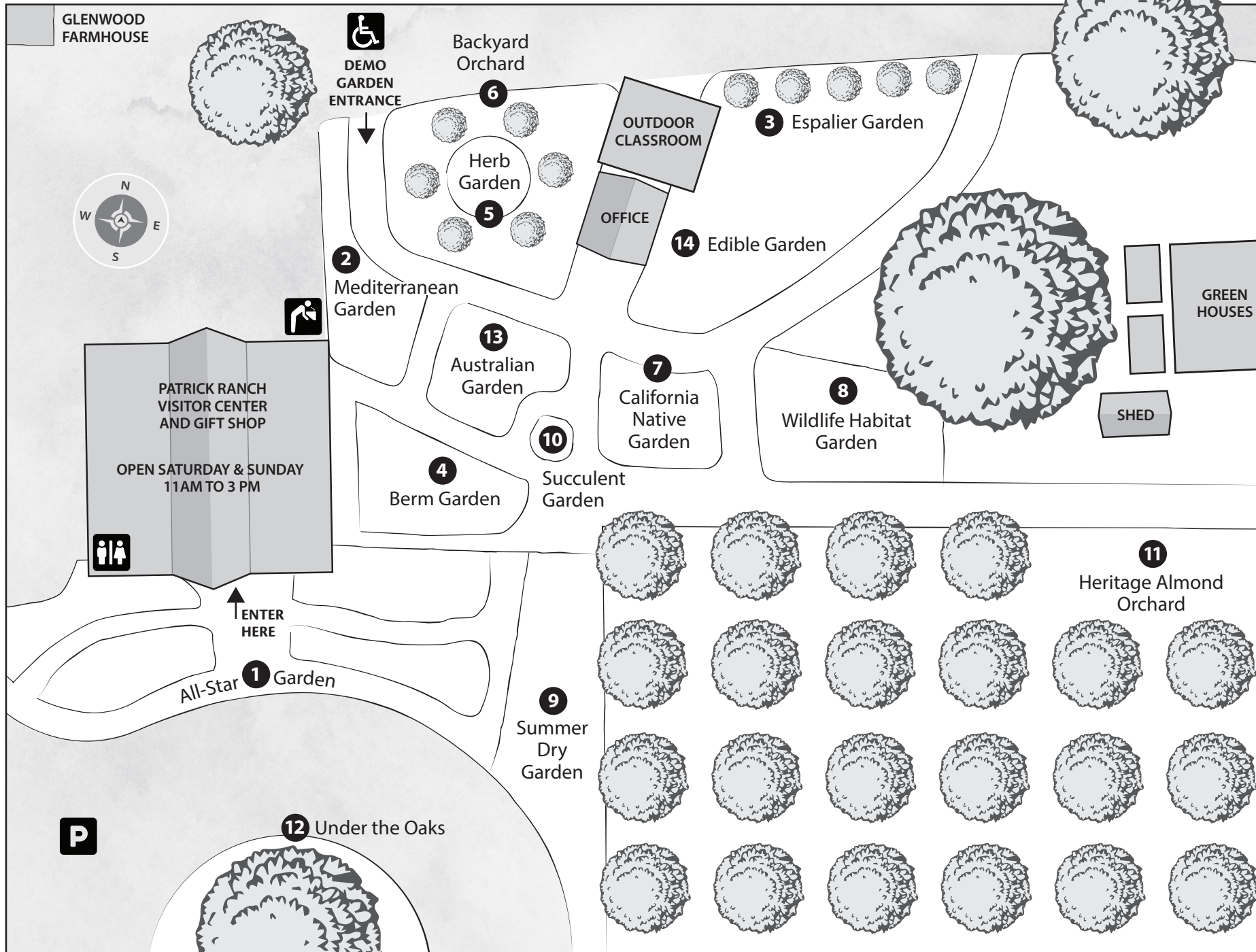

A Garden for Today: Sustainable, Functional, Beautiful

Located at the historic Patrick Ranch Museum, the UC Master Gardeners of Butte County Demonstration Garden consists of multiple gardens offering examples of landscape choices and strategies. These gardens are used for public education classes and workshops, and our outdoor classroom is integrated into the design.

The overall garden concept was drafted, and the first gardens were planted, in 2013. The plan was bold: converting a barren one-acre plot into a series of themed gardens highlighting the possibilities available to gardeners in Butte County. Featured are drought resistant, native plants; plants that attract pollinators; plants that thrive in our climate; sustainable gardening practices; backyard food production methods; and a variety of hardscape design choices.

Learn more about the Demonstration Garden by visiting our website or at ucanr.edu/p/49547.



Funding generously provided by Support Group of Butte County UCCE.